

Catalogue No	D. cable	MASS
LF170080-A	5	
LF170080-B	11	
LF170080-C	13	
LF170080-D	15	
LF170080-E	18	
LF170080-F	30	
LF170080-G	42	
LF170080-H	45	

Catalogue No	MATERIAL	MASS	H2	D STUD
LF170079-A	AL	2.3	125	60
LF170079-B	AL	16	125	30
LF170079-C	CU	6.2	125	60
LF170079-D	CU	3.6	125	30
LF170079-E	CU/SN	6.2	125	60
LF170079-F	CU/SN	3.6	125	30
LF170079-G	CU/AG	6.2	125	60
LF170079-H	CU/AG	3.6	125	30

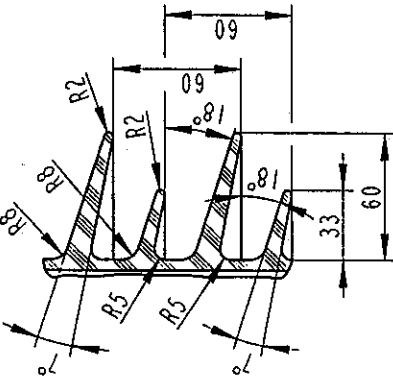
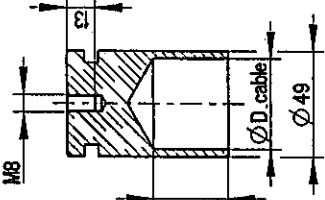

**ELECTRICAL DATA, according to IEC 137**

Ratings	Rated voltage	73 kV
	Max phase to earth voltage, temporary	73 kV
	Max current with Cu-conductor	2000 A
	Max current with stranded cable 740 mm <sup>2</sup>	1000 A
	Dry lightning impulse	350 kV
	Wet power frequency	140 kV
Routine test	Dry power frequency	160 kV
Capacitance	Nominal capacitance	610 pF

**GENERAL DATA, according to IEC 137**

Silicone rubber insulator	Creepage distance	2323 mm
	Protected creepage distance	1000 mm
Colour		GREY RAL 7035
Mass	Mass bushing	21 kg
Cantilever load	Cantilever test load, heavy load	3150 N
	Max cantilever operating load, bushing	575 N
Temp class	Temperature class	CLASS 2
Mounting and service instructions		2750.515-115

**ELECTRICAL DATA according to ANSI C57.19.00**

Ratings	Insulation class	69 kV
	Rated max. line to ground voltage	44 kV
	Max current with Cu-conductor	2000 A
	Max current with stranded cable 740 mm <sup>2</sup>	1000 A

Dim. requirements acc. to C57.19.01 not fulfilled.

**ABB Components** Luleå, Sweden  
 GSA73-0A/2000/05 LF90073-9C

No. 73/73 W 2000 A 50/60 Hz  
 U / S / AC 350 / - / 160 kV  
 H 21 kg L 760 mm V 0-90  
 C1 pF Tan δ  
 C2 pF Tan δ

Signatures acc. to  
 Revision 0 are valid  
 Signaturer enligt  
 Revision 0 gäller

Responsible department	COM/BKU 96 44
Take over department	JACOBSON
Database	JACOBSON
Page	82
Page	1(1)

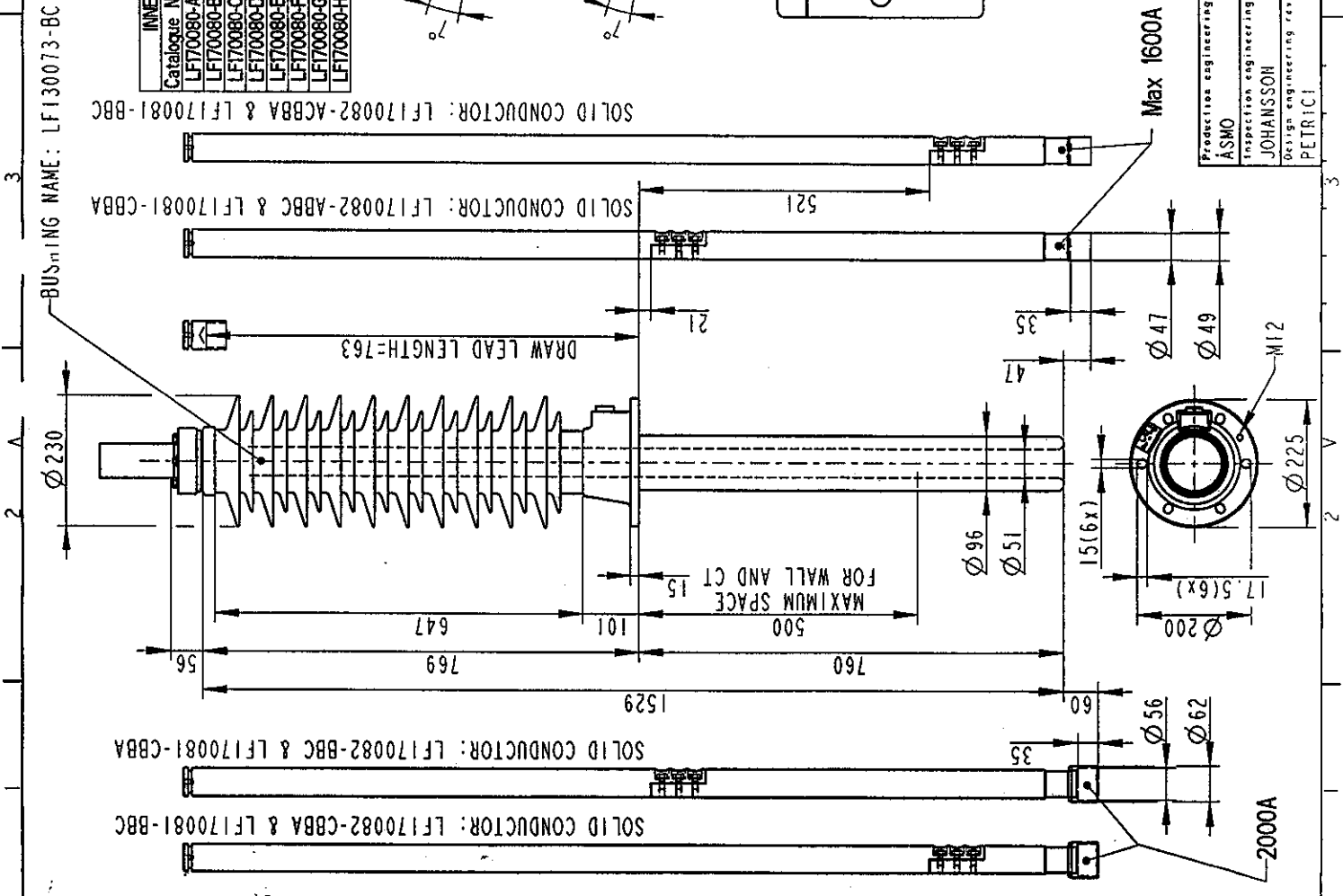

**ABB** ABB Components  
 2751362-BBC